



NEW PRODUCT

December 7, 2022



Manufacturing Valvetrain For 80-Years & 2-Generations

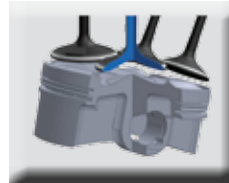
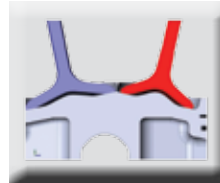
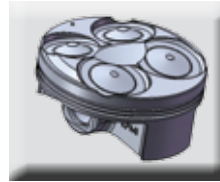

YAMAHA

TOP END SERVICE KITS - STAINLESS CONVERSION

AVAILABLE NOW

Manufactures	Yamaha®
Years	2014-2016
Models	WR™/ YZ™ 250F

KPMI P/N	Piston Bore Size	Type	Max Valve Lift	Installed Height	Seat Pressure	Open Pressure	@ Lift	
80-81200	77.00mm	Intake	.395"	1.150"	55#	151#	.395"	
		Exhaust	.370"	1.100"	46#	119#	.370"	
Kit Includes	2	In Titanium Retainers		2	In CrSi Valve Springs		2 In H. T. Steel Basewashers	
	2	Ex Titanium Retainers		2	Ex CrSi Valve Springs		2 Ex H. T. Steel Basewashers	
	2	In Black Diamond™ Valves			2	Ex Black Diamond™ Valves		
	1	High Compression Racing Piston Kit			1	Top End Gasket Kit		

IMPORTANT NOTE: The piston assembly (piston, rings, valves, pin and pin clips) in this kit are designed to work together as a system. When used complete, the piston assembly can be used as an OEM replacement. The individual components are **NOT INTERCHANGEABLE** with O.E.M. valves and piston assembly components

Retail	\$610.76
--------	----------

Components • Replacement • Top End Service Kit

KPMI P/N	Description	Retail
80-81400	Spring Kit	\$220.26
80-80912	Intake, Standard Valve	\$31.01
80-80916	Exhaust, Standard Valve	\$31.01
80-81201	Gasket Kit	\$60.99

ALL KIT CONTENTS

- Piston, Rings, Clips and Pin – (2618 Alloy Fully CNC Machined Race Piston)
- Complete Top End Gasket Kit by Cometic™
- KPMI® S.S. Black Diamond™ Valves, Stock Head Dia. (All Valves)
- Complete Dual Spring / High Performance Titanium Retainer Spring Kit

FEATURES

- Complete piston assembly, gasket kit and valves to rebuild or service your bikes top end
- Cost saving built into purchasing these components as a kit
- Designed specifically for the performance demands of MX Bikes and Quads
- Pistons designed to maintain stock compression
- 2618 Alloy Fully CNC Machined Piston with performance skirt coating
- KPMI® High Performance Valvetrain is known to outlast OEM by twice the service life
- Lightweight Racing Spring Kit compatible with high performance cams

Contact a KPMI® Sales Representative Today!

650-557-2046, Ext. 802

VISIT US AT WWW.KPMI.US