

# TOP END SERVICE KITS - STAINLESS CONVERSION

February 26, 2024



SUZUKI / YAMAHA

**AVAILABLE NOW**

**NEW PRODUCTS**

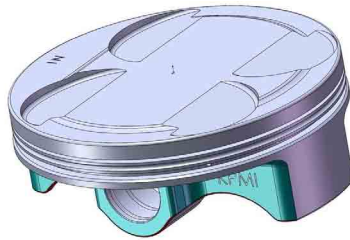

## ALL KIT CONTENTS

- Piston, Rings, Clips and Pin – (2618 Alloy Fully CNC Machined Race Piston)
- Complete Top End Gasket Kit by Cometic™
- KPMI® S.S. Black Diamond™ or White Diamond® Valves, Stock Head Dia. (All Valves)
- Complete Dual Spring / High Performance Titanium Retainer Spring Kit

## FEATURES

- Complete piston assembly, gasket kit and valves to rebuild or service your bikes top end
- Cost saving built into purchasing these components as a kit
- Designed specifically for the performance demands of MX Bikes and Quads
- Pistons designed to maintain stock compression
- 2618 Alloy Fully CNC Machined Piston with performance skirt coating
- KPMI® High Performance Valvetrain is known to outlast OEM by twice the service life
- Lightweight Racing Spring Kit compatible with high performance cams

**IMPORTANT NOTE:** The piston assembly (piston, rings, pin and pin clips) in this kit are designed to work together as a system. When used complete, the piston assembly can be used as an OEM replacement. The individual components are **NOT INTERCHANGEABLE** with O.E.M. piston assembly components.

### Top End Service Kit For Suzuki® LTR450 2006-2009

KPMI P/N	Piston Bore Size	Type	Max Valve Lift	Installed Height	Seat Pressure	Open Pressure	@ Lift			
60-61900	95.50mm	Intake	.415"	1.190"	61#	168#	.415"			
		Exhaust	.415"	1.215"	56#	157#	.415"			
Kit Includes			2	In Titanium Retainers	2	In CrSi Valve Springs	2	In H. T. Steel Basewashers		
			2	Ex Titanium Retainers	2	Ex CrSi Valve Springs	2	Ex H. T. Steel Basewashers		
			2	In Std. Black Diamond™ Valves			2	Ex Std. Black Diamond™ Valves		
			1	High Performance Piston Kit			1	Top End Gasket Kit		

### Components • Replacement • Top End Service Kit For Suzuki® LTR450 2006-2009

KPMI P/N	Description	Specification
60-60280	Spring Kit	Includes: Ti Retainers, CrSi Valve Springs, H.T. Steel Basewashers
60-60310	In Std. Black Diamond™ Valves	Valves • Black Diamond™ • Stainless
60-60313	Ex Std. Black Diamond™ Valves	Valves • Black Diamond™ • Stainless
60-61901	Gasket Kit	Includes: Head Base Gasket 96mm Bore(1), Base Gasket(1), Exhaust Gasket(1), Cam Chain Tensioner Gasket(1), Valve Stem Seals(4)

### Top End Service Kit For Yamaha® YFZ 450 2004-2009

KPMI P/N	Piston Bore Size	Type	Max Valve Lift	Installed Height	Seat Pressure	Open Pressure	@ Lift			
80-82700	95.00mm	Intake	.380"	1.105"	39#	86#	.380"			
		Exhaust	.380"	1.105"	39#	86#	.380"			
Kit Includes			3	In Titanium Retainers	3	In CrSi Valve Springs	3	In H. T. Steel Basewashers		
			2	Ex Titanium Retainers	2	Ex CrSi Valve Springs	2	Ex H. T. Steel Basewashers		
			2	In Std. (Outer) White Diamond® Valves			1	In Std. (Center) White Diamond® Valves		
			3	In Viton® Seals			2	Ex Viton® Seals		
			1	High Performance Piston Kit			1	Top End Gasket Kit		

VISIT US AT [WWW.KPMI.US](http://WWW.KPMI.US)



# TOP END SERVICE KITS - STAINLESS CONVERSION

February 26, 2024

## Components • Replacement • Top End Service Kit For Yamaha® YFZ 450 2004-2009

KPMI P/N	Description	Specification
80-80206	Spring Kit	Includes: Ti Retainers, CrSi Valve Springs, H.T. Steel Basewashers, Viton® Seals
80-80213H	Intake, Standard (Outer) Valve	Valves • White Diamond® • Stainless
80-80215H	Intake, Standard (Center) Valve	Valves • White Diamond® • Stainless
80-80217H	Exhaust, Standard Valve	Valves • White Diamond® • Stainless
80-82701	Gasket Kit	<b>Includes:</b> Head Gasket 95mm (1), Base Gasket (1), Exhaust Gasket (1), Cam Chain Tensioner Gasket (1), Oil Line Washers (2), Head Drain Washers (1), Oil Line Washers 4 Req (1).

## Top End Service Kit For Yamaha® YFZ 450R 2009-2023

KPMI P/N	Piston Bore Size	Type	Max Valve Lift	Installed Height	Seat Pressure	Open Pressure	@ Lift
80-82750	95.00mm	Intake	.380"	1.105"	39#	86#	.380"
		Exhaust	.380"	1.105"	39#	86#	.380"
Kit Includes		3	In Titanium Retainers	3	In CrSi Valve Springs	3	In H. T. Steel Basewashers
		2	Ex Titanium Retainers	2	Ex CrSi Valve Springs	2	Ex H. T. Steel Basewashers
		2	In Std. (Outer) White Diamond® Valves	1	In Std. (Center) White Diamond® Valves	2	Ex Std. White Diamond® Valves
		3	In Viton® Seals		2	Ex Viton® Seals	
		1	High Performance Piston Kit		1	Top End Gasket Kit	

## Components • Replacement • Top End Service Kit For Yamaha® YFZ 450R 2009-2023

KPMI P/N	Description	Specification
80-80206	Spring Kit	Includes: Ti Retainers, CrSi Valve Springs, H.T. Steel Basewashers, Viton® Seals
80-80213H	Intake, Standard (Outer) Valve	Valves • White Diamond® • Stainless
80-80215H	Intake, Standard (Center) Valve	Valves • White Diamond® • Stainless
80-80217H	Exhaust, Standard Valve	Valves • White Diamond® • Stainless
80-82751	Gasket Kit	<b>Includes:</b> Head Gasket 95mm (1), Base Gasket (1), Exhaust Gasket (1), Cam Chain Tensioner Gasket (1), Oil Line Washers (2), Head Drain Washers (1), Oil Line Washers 4 Req (1).

## Retail Price List

KPMI P/N	Description	Retail
60-61900	Top End Service Kit For Suzuki® LTR450 2006-2009	\$707.70
60-61901	Gasket Kit, Replacement	\$67.26
60-60280	Spring Kit	\$220.26
60-60310	Valve, Black Diamond™, In Std.	\$37.55
60-60313	Valve, Black Diamond™, Ex Std.	\$37.55
80-82700	Top End Service Kit For Yamaha® YFZ 450 2004-2009	\$736.36
80-82701	Gasket Kit, Replacement	\$109.31
80-80206	Spring Kit	\$317.71
80-80213H	Valve, White Diamond®, In Std. (Outer)	\$37.55
80-80215H	Valve, White Diamond®, In Std. (Center)	\$37.55
80-80217H	Valve, White Diamond®, Ex Std.	\$736.36
80-82750	Top End Service Kit For Yamaha® YFZ 450R 2009-2023	\$736.36
80-82751	Gasket Kit, Replacement	\$90.26

Contact a KPMI® Sales Representative Today!

**650-557-2046, Ext. 802**

**ORDER 650-557-2046**